



U S B

3.0

USB 3.0 is the next major revision to the Universal Serial Bus standard. This new revision promises higher data transfer rates (up to 4.8Gbps) with increased maximum bus power and is backwards compatible to USB 2.0.

PART NUMBER REFERENCE

U S B 3.X.X.X.() M

Select Connector Type: End "1"

- Type A Friction Fit = 1
- Straight MICRO-B Exit with Thumbscrews = 2
- MICRO-B R/A **UP** w/Recessed Screws = 3
- MICRO-B R/A **DOWN** w/Recessed Screws = 4
- MICRO-B Exit Right w/Recessed Screws = 5
- MICRO-B Exit Left w/Recessed Screws = 6
- Type A with Thumbscrews = 7
- Type B with Thumbscrews = 8
- Type B Friction Fit = 9
- Type A Receptacle Friction Fit = 10
- Type A Receptacle w/Threaded Inserts = 11
- Type B w/Threaded Inserts = 12

Cable Type Options:

- STATIC = 1
- ROBOTIC = 2

Select Connector Type: End "2"

- Type A Friction Fit = 1
- Straight MICRO-B Exit with Thumbscrews = 2
- MICRO-B R/A **UP** w/Recessed Screws = 3
- MICRO-B R/A **DOWN** w/Recessed Screws = 4
- MICRO-B Exit Right w/Recessed Screws = 5
- MICRO-B Exit Left w/Recessed Screws = 6
- Type A with Thumbscrews = 7
- Type B with Thumbscrews = 8
- Type B Friction Fit = 9
- Type A Receptacle Friction Fit = 10
- Type A Receptacle w/Threaded Inserts = 11
- Type B w/Threaded Inserts = 12

Option: Length in Meters

CONNECTOR TYPE OPTIONS:

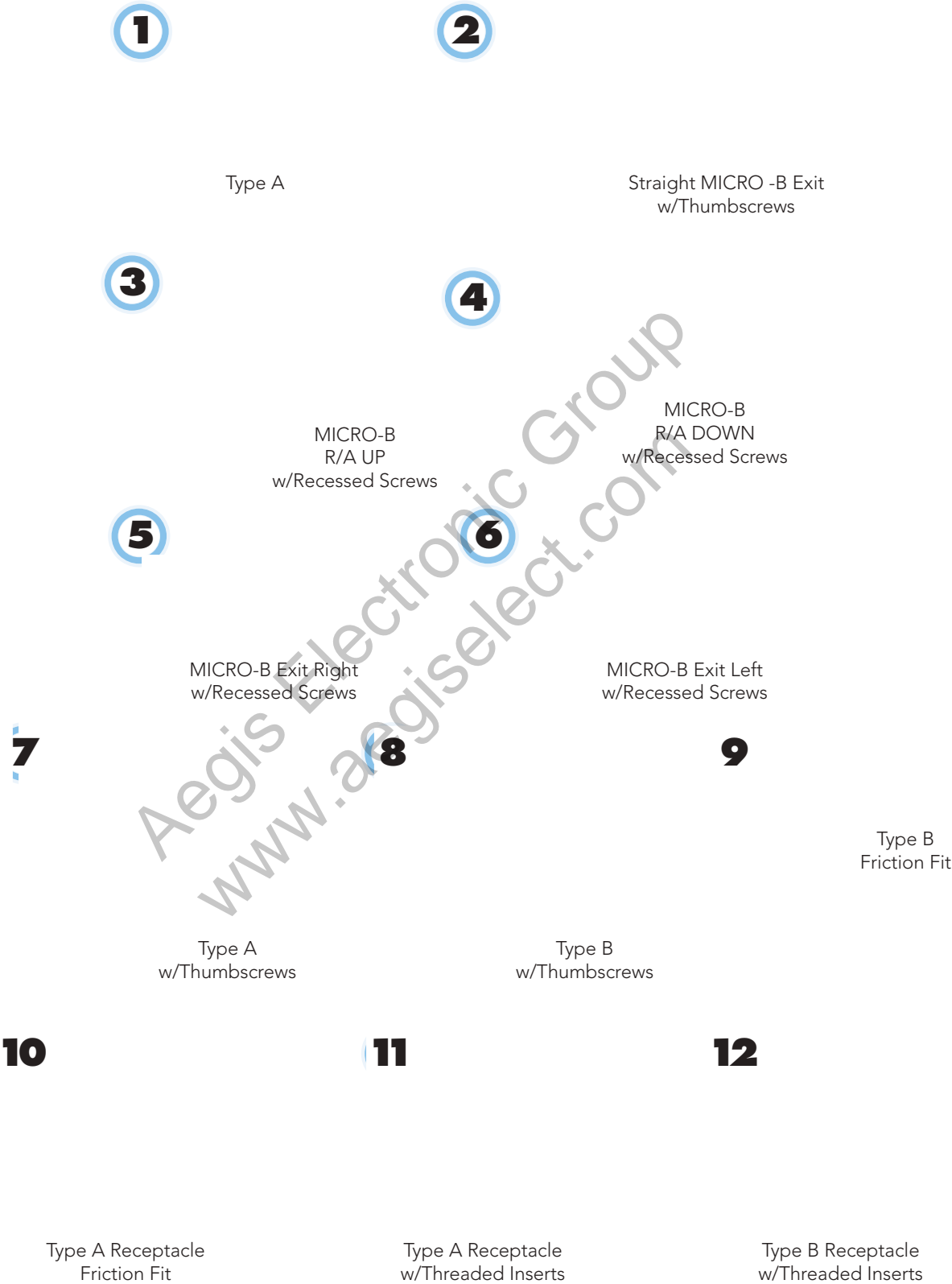



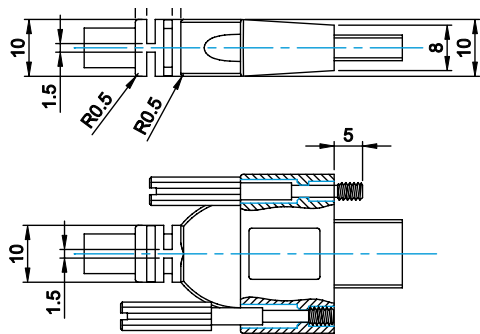

PROFILE 7

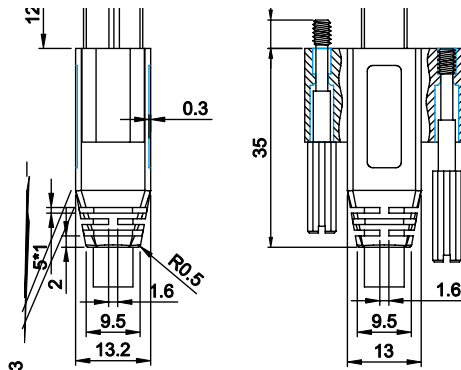

PROFILE 8

USB 3.0 B MALE

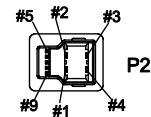

PROFILE 9

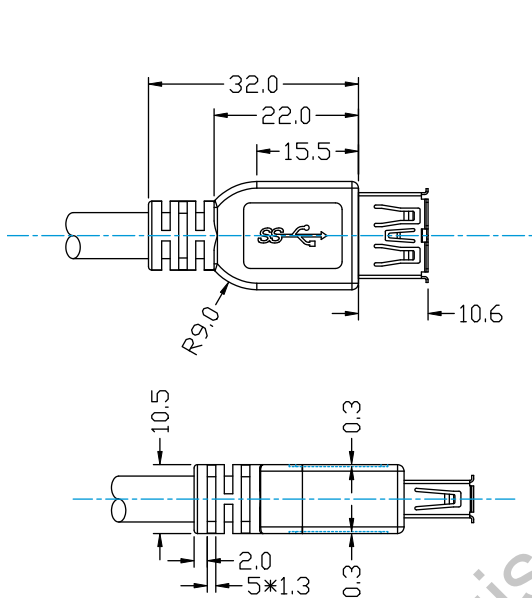

PROFILE 10

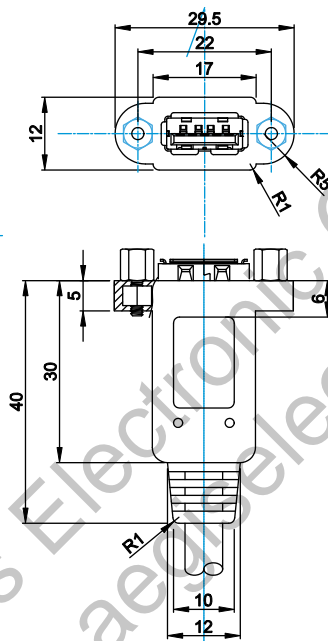

PROFILE 11

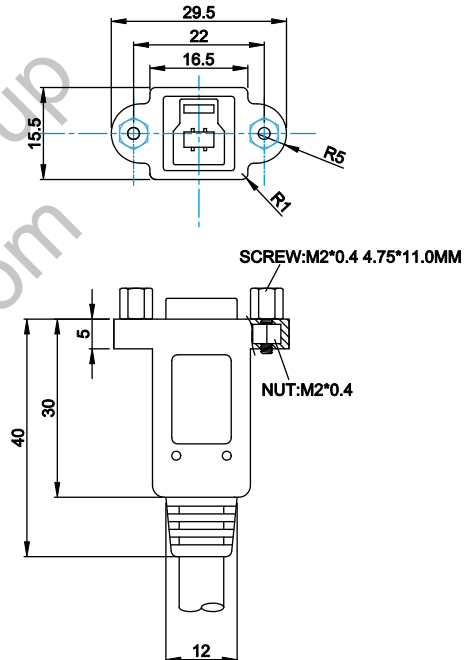

PROFILE 12

USB 3.0 A MALE

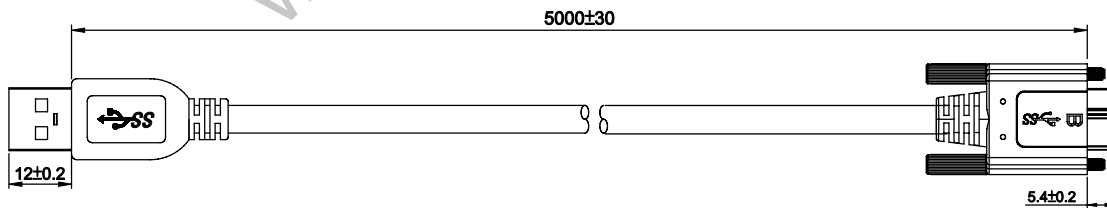
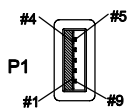

USB3.0 MICRO-B MALE

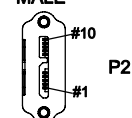

USB 3.0 A MALE

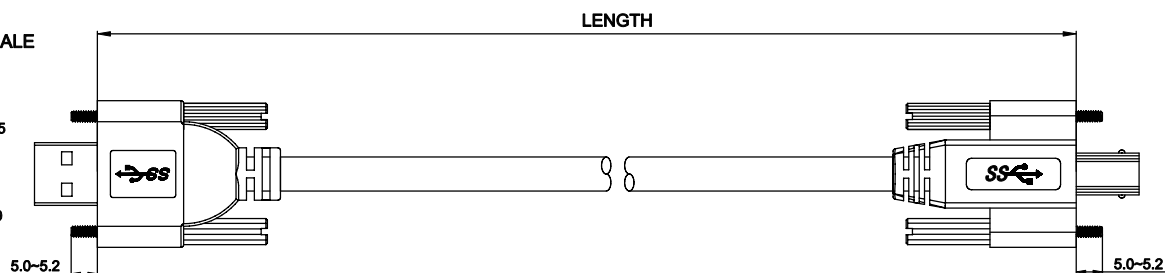
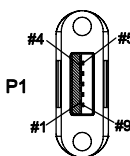

USB 3.0 B MALE

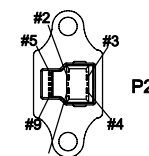



CAMERA LINK HS CABLES

The Camera Link HS interface is a new machine vision connectivity standard. As a group we are working with the Camera Link HS subcommittee to bring reference designs and a more complete specification to the table for industry use as the next generation Machine Vision interface.

PART NUMBER REFERENCE **H S - X - X - X - () M**

Connector Type: End "A"

- CX4 Die Cast Backshell with Screws = 1
- CX4 Die Cast Backshell with Latches = 2
- SFP+ = 3
- SFP+ Fiber = 4

Cable Type Options:

- CX4 = 1
- HIFLEX CX4 = 2
- SFP+ Copper = 3
- SFP+ Fiber = 4

Connector Type: End "B"

- CX4 Die Cast Backshell with Screws = 1
- CX4 Die Cast Backshell with Latches = 2
- SFP+ = 3
- SFP+ Fiber = 4

Option: Length in Meters

Key features include:

- Camera Link HS Interface - next generation image acquisition interface
- Diecast hood with thumbscrews
- Ultra compact, field proven 26 AWG CX4 cable and connector
- Dedicated communication channel supports data rates up to 3.125 Gbits/s

HS-1-1-1-()M

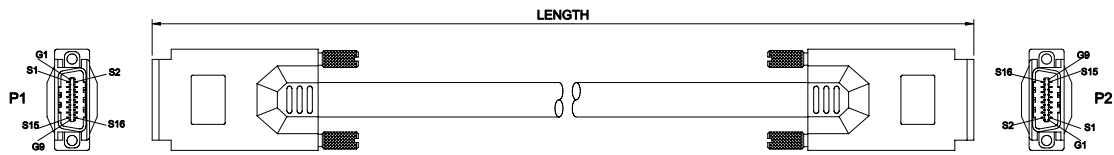

HS-1-1-2-()M

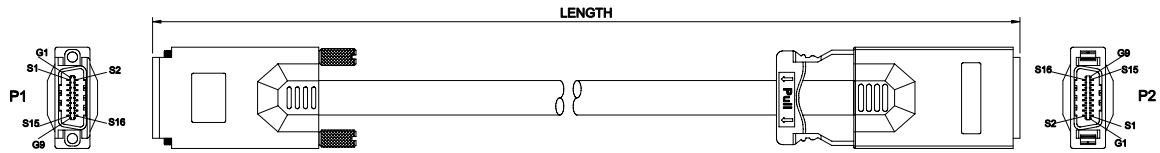

HS-3-1-3-()M

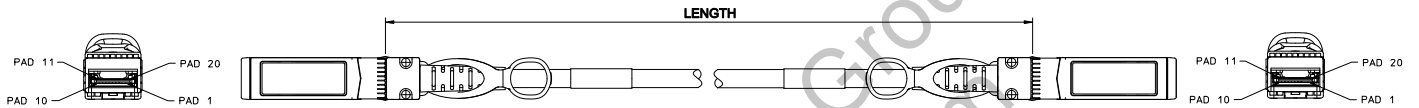

1

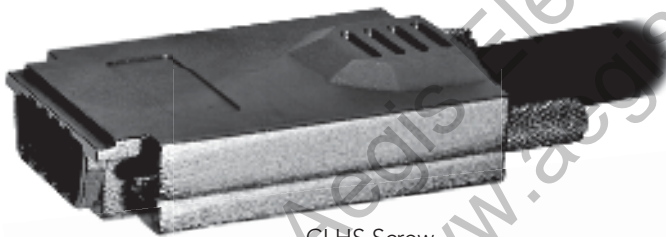

CLHS Screw

2

CLHS Latch

3

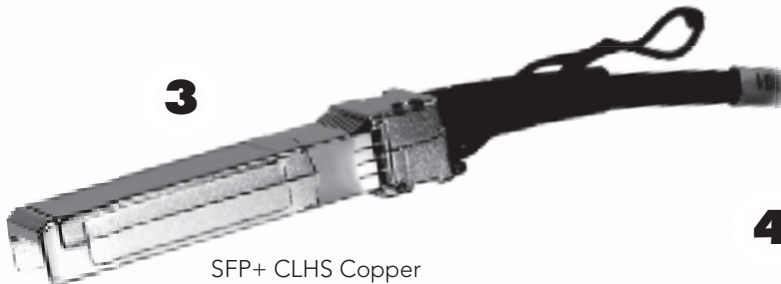

SFP+ CLHS Copper

4

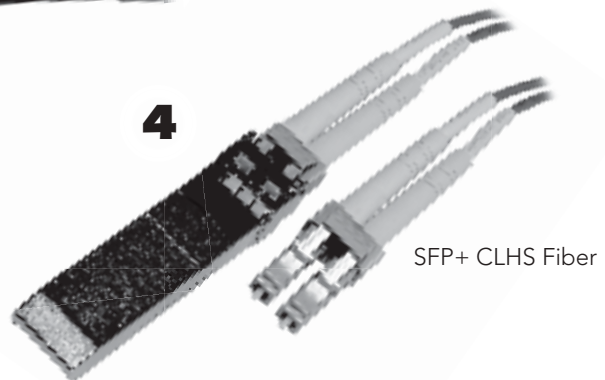

SFP+ CLHS Fiber



CoaXPress CABLES

NEXT GENERATION DIGITAL INTERFACE

PART NUMBER REFERENCE

C | **X** | **X** | **X** | **X** | **X** | **X** | **X** | **X** | **X**

Select Connector Type: End "A"

BNC = 1
5W5 = 2
DIN 1.0/2.3 = 3

Use "0" for Non-molded
Multiple DIN 1.0/2.3 ONLY

Quantity of Connectors:

0*, 1, 2, 3, 4, or 5
(See page 39 for DIN Configurations:
Types 41, 4, 22, 21, 2, 1 & 34R)

**Cable Type Options:

Miniature Coax = 1
HIFLEX RG59 = 2
RG6 = 3

Select Connector Type: End "B"

BNC = 1
5W5 = 2
DIN 1.0/2.3 = 3

Use "0" for Non-molded
Multiple DIN 1.0/2.3 ONLY

Quantity of Connectors:

0*, 1, 2, 3, 4, or 5
(See page 39 for DIN Configurations:
Types 41, 4, 22, 21, 2, 1 & 34R)

Option: Length in Meters

* For use with 5W5 connector only.

**Reflects cable style used, see specification sheet for dimensional information per configuration.

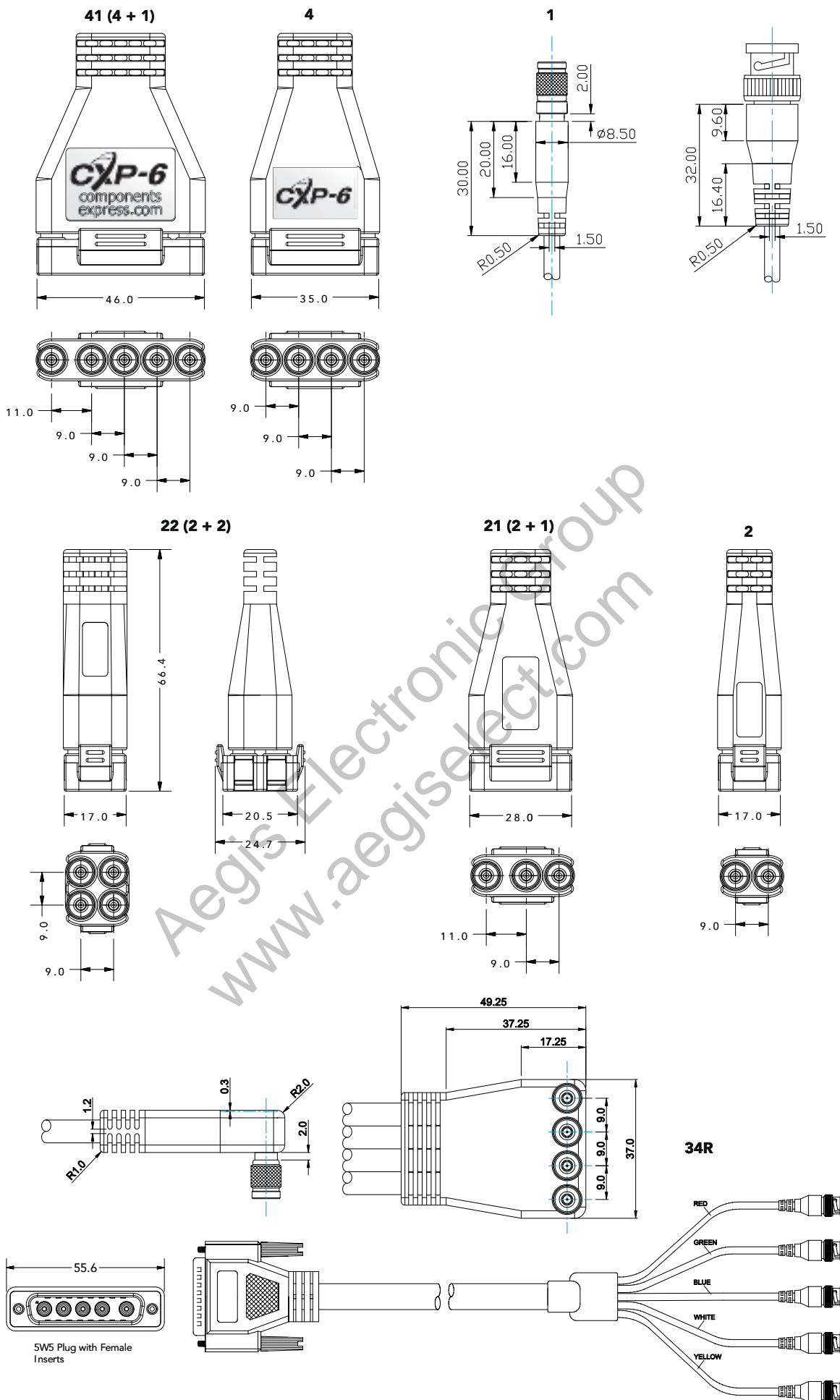



POWER SUPPLIES & CUSTOM I/O BREAKOUT CABLES FOR MACHINE VISION

Components Express Inc. offers three different style power supplies. All power supplies are available with either 4, 6, or 12 pin Hirose connectors. Custom power connectors are also available for various applications upon request.



Desktop part #PS-12-12P

Input: 100~240 VAC
Output: 12VDC, 1.25A

Description:

The SPU16A series of AC/DC switching mode power supplies provide 15 Watts of continuous output power and is well-suited for a variety of applications. All supplies are UL 94V-1 min compliant. All models meet FCC Part-15 class B and CISPR-22 class B emission. Limits and are designed to comply with UL/c-UL (UL 60950-1), TUV/GS (EN 60950-1) and new CE requirements. All units are 100% burn-in and tested.



Universal Wall Mount part #UPS-12-12P

Input: 100~240 VAC
Output: 12VDC, 1.25A

**HIGHER WATTAGE
MODELS AVAILABLE**



Wall Mount part #WPS-12-12P

Input: 120 VAC
Output: 12VDC, 800mA

See page 41 – 44 for profile drawings.

REV. C

PS-12-12P

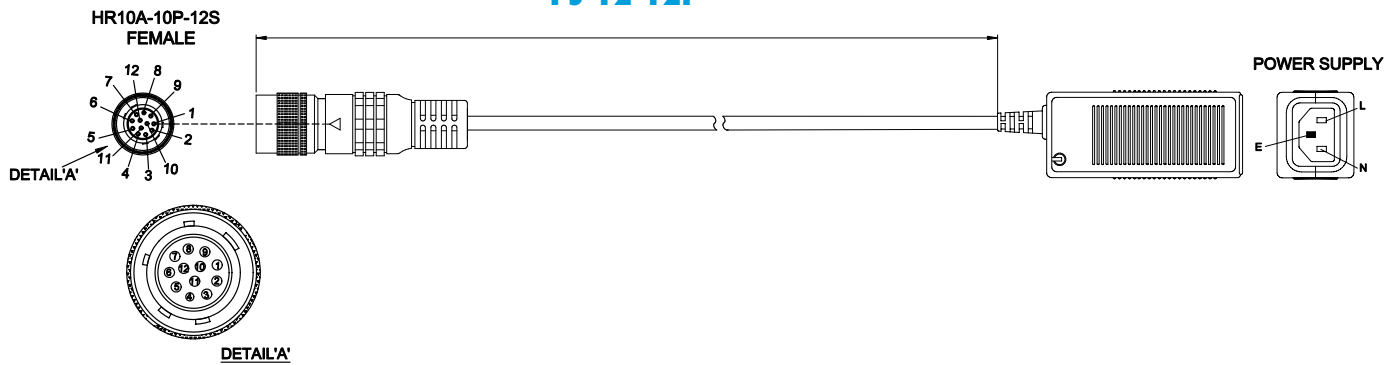

CY-S-0856

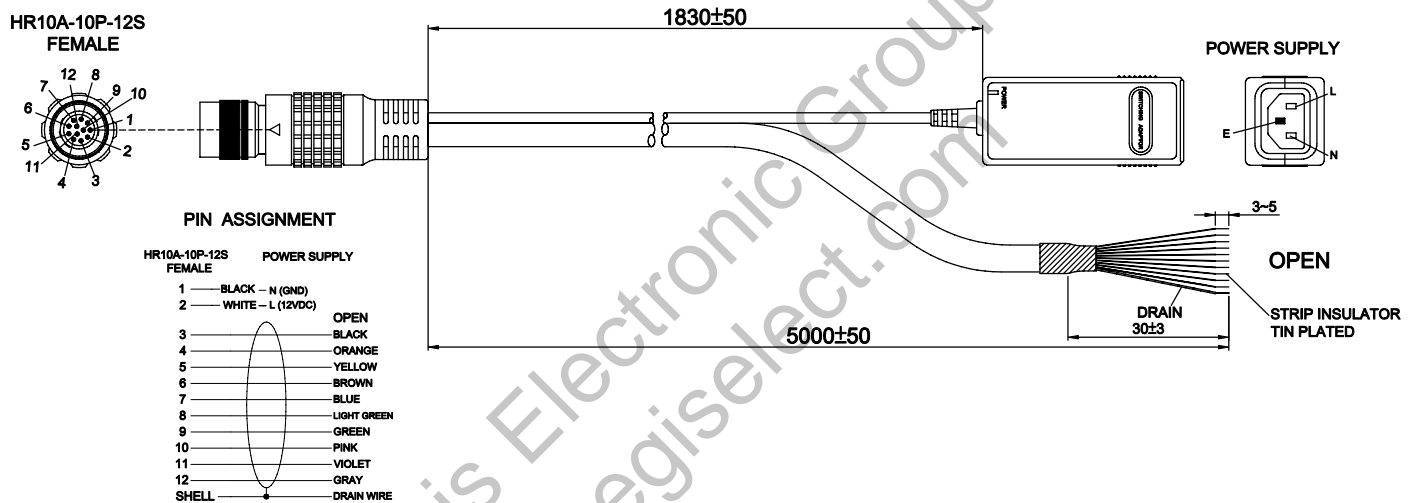

CY-S-0299

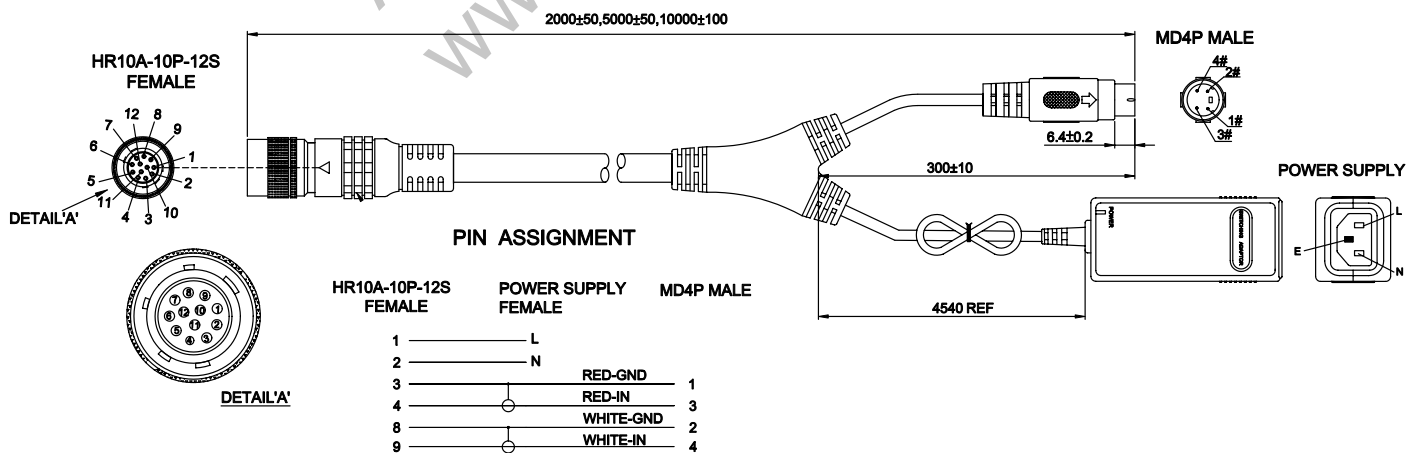

CY-S-0367

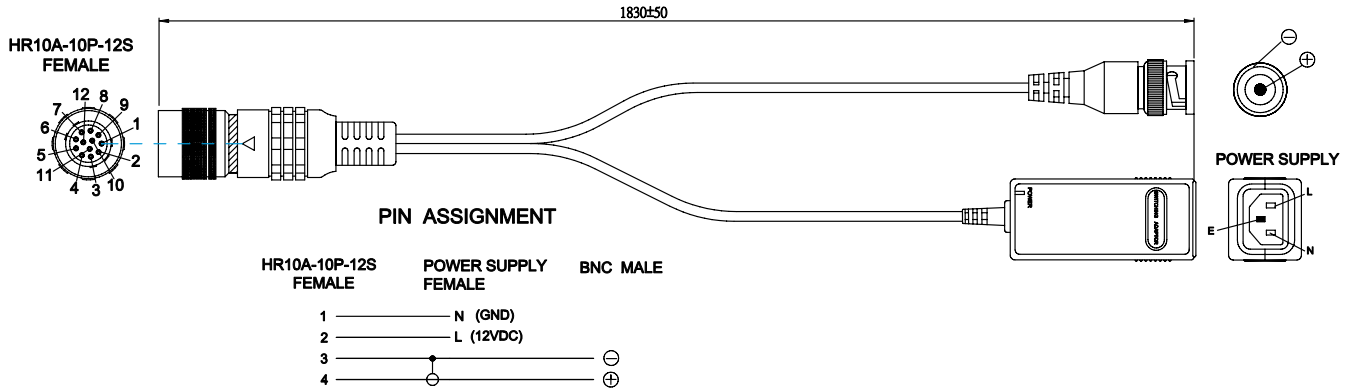

CY-S-0562

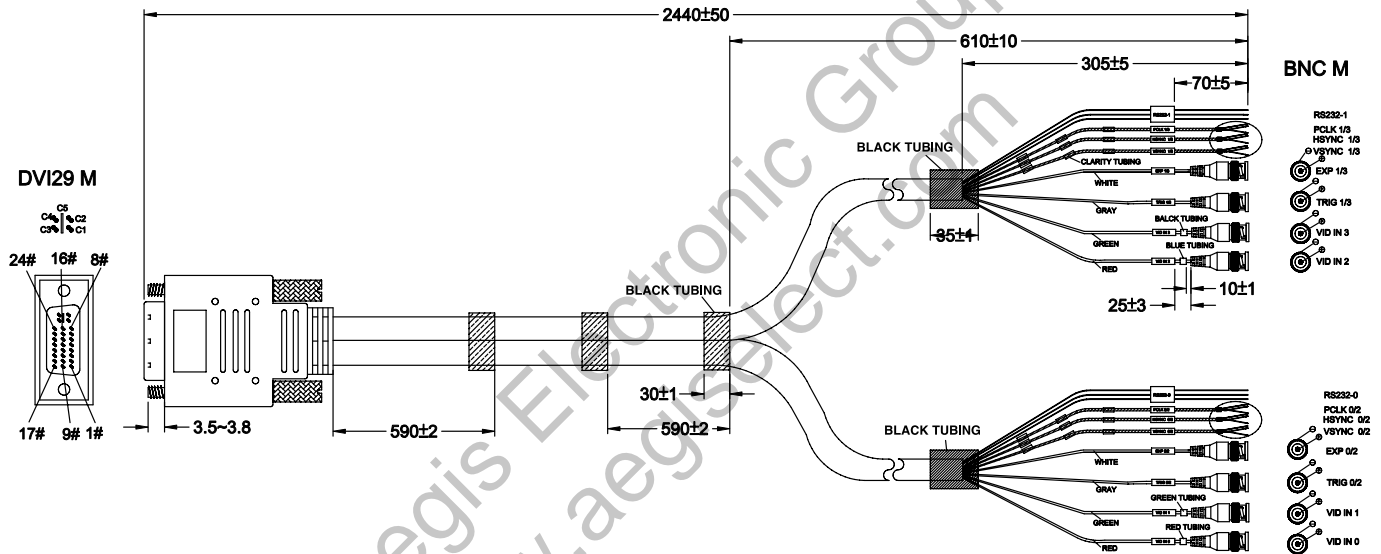

G2-IOPC-MD25F

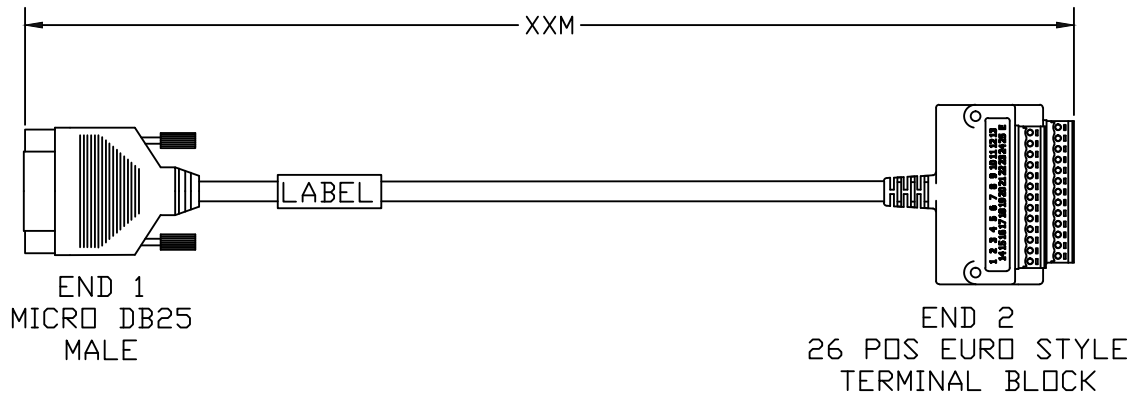

REV. C

CY-S-0527

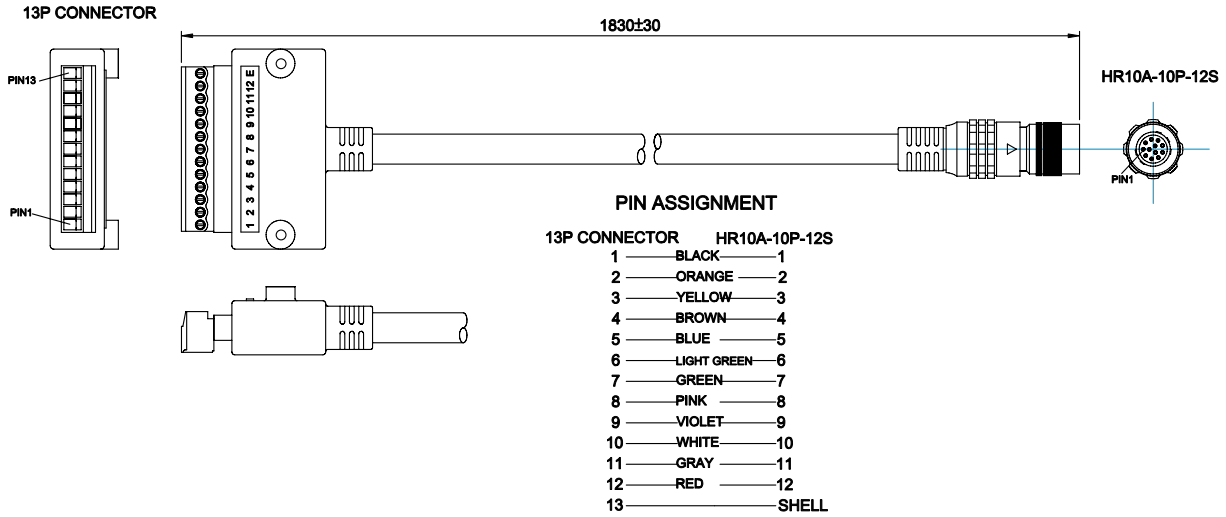

CY-S-0462

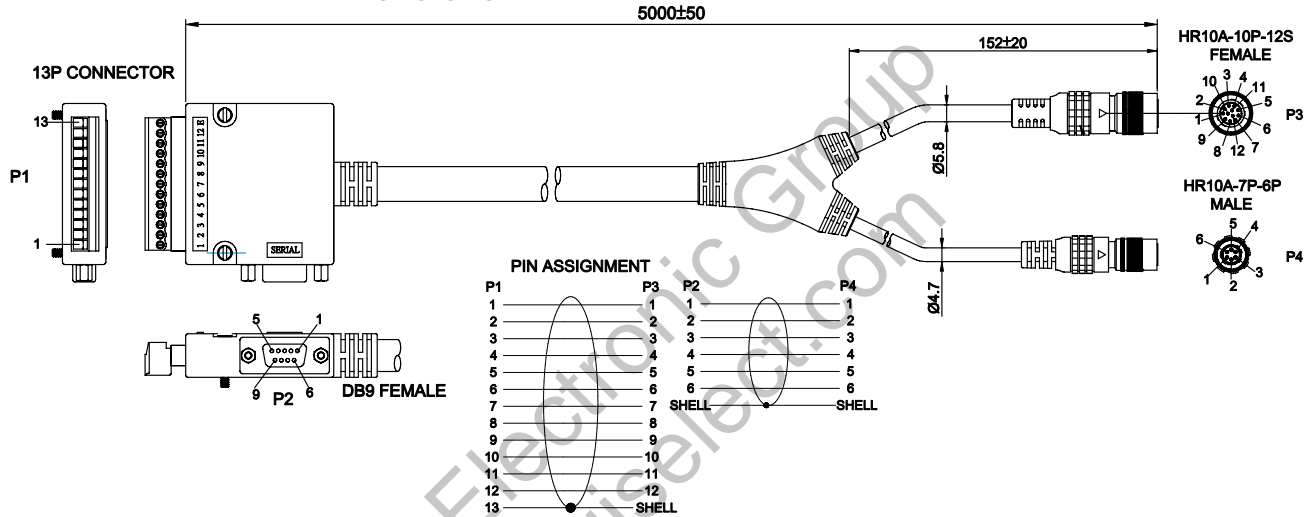

D-SW88D-()M

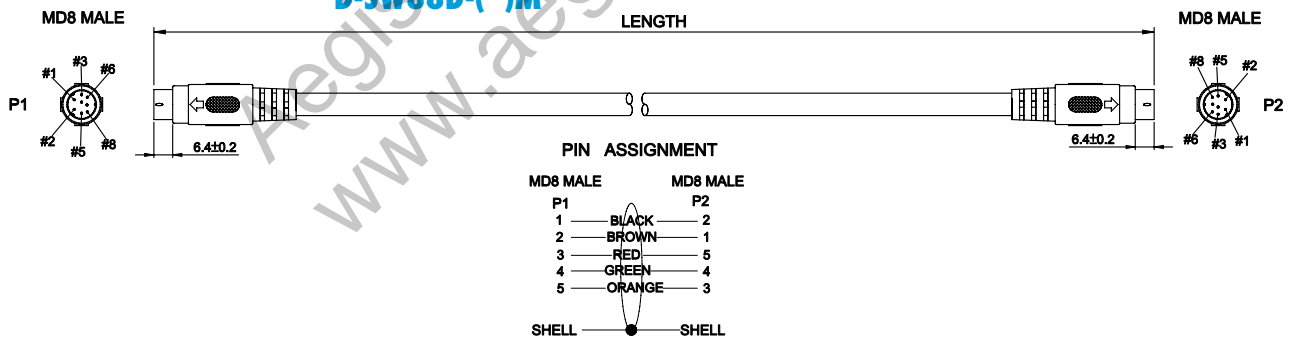

RC893/1-()M

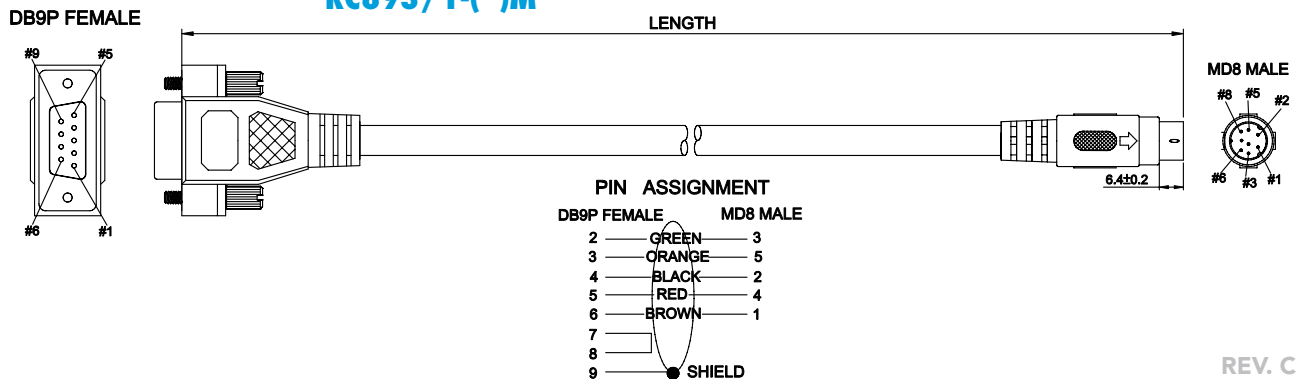

REV. C